



# SCOUT

140MM REAR / 150MM FRONT / 27.5 WHEELS

- SCOUT**
- OVERVIEW/BUY
- BUILDS/PRICING
- SBG GEOMETRY
- FEATURES
- REVIEWS
- SPECS
- FAQ'S
- SUPPORT/SETUP



## THE COMPOSED SPORT BIKE

Hop on the Scout and you're immediately transformed into a projectile.

The Scout will awaken your inner child. Manual here, scrub that, skid there, pedal up this. Freedom to boost everything in sight, overshoot every landing without a care, mixed with nose bonking and hooting your way

### STEP 1. SELECT BUILD

- XG1** \$6,599 USD
- GX** \$5,499 USD
- NX** \$4,499 USD
- FRAMESET** \$3,199 USD

### STEP 2. SELECT SIZE AND COLOR

- |   |   |
|---|---|
| <input type="checkbox"/> X-Small Out-of-Stock | <input type="checkbox"/> X-Small Out-of-Stock |
| <input type="checkbox"/> Small Preorder Now   | <input type="checkbox"/> Small Preorder Now   |
| <input type="checkbox"/> Medium Preorder Now  | <input type="checkbox"/> Medium Preorder Now  |
| <input type="checkbox"/> Large Preorder Now   | <input type="checkbox"/> Large Preorder Now   |

down the trail. Sporty, but just as eager to tackle bigger terrain. The Scout's trail charisma is infectious and will cause you to look at your regular trails through a new perspective. Pedal up and repeat.

**X-Large** In-Stock

**X-Large** In-Stock

**ADD TO CART** \$3,199.00 USD

IN STOCK: This item will ship within 2 business days

AVAILABLE COLORS: ■ MIDNIGHT BLUE ■ OLIVE GREEN



	<b>XG1</b>	<b>GX</b>	<b>NX</b>	<b>FRAMESET</b>
<b>PRICE</b>	\$6599 USD	\$5499 USD	\$4499 USD	\$3199 USD
<b>FRAME</b>	Scout Carbon 140mm	Scout Carbon 140mm	Scout Carbon 140mm	Scout Carbon 140mm
<b>REAR SHOCK</b>	Fox Float X2 Performance Elite	RockShox Super Deluxe Ultimate	RockShox Super Deluxe Select+ RT	Fox Float X2 Performance Elite
<b>FORK</b>	Fox Float 36 Grip 2 Performance Elite 150mm Travel/37mm Offset	RockShox Lyrik Ultimate 150mm Travel/37mm Offset	RockShox Lyrik Select 150mm Travel/37mm Offset	
<b>HEADSET</b>	Cane Creek 40 Series	FSA No.57E	FSA No.57E	
<b>STEM</b>	ANVL Swage (40mm)	ANVL Swage (40mm)	RaceFace Aeffect R (40mm)	
<b>HANDLEBAR</b>	OneUp Carbon Bar XS/SM (800x20) MD/LG/XL (800x35)	ANVL Mandrel Alloy 35 XS/SM (800x20) MD/LG (800x30) XL (800x40)	RaceFace Chester 35 XS/SM (780x20) MD/LG/XL (780x35)	
<b>GRIPS</b>	Sensus Lite	Sensus Lite	Sensus Lite	
<b>SADDLE</b>	ANVL Forge Ti	ANVL Forge Cromo	ANVL Forge Cromo	
<b>SEATPOST</b>	OneUp Dropper Post XS (120mm) SM (150mm) MD (180mm) LG/XL (210mm)	OneUp Dropper Post XS (120mm) SM (150mm) MD (180mm) LG/XL (210mm)	OneUp Dropper Post XS (120mm) SM (150mm) MD (180mm) LG/XL (210mm)	
<b>BRAKES</b>	SRAM Code RSC	SRAM Code RSC	SRAM Code R	
<b>ROTOR</b>	SRAM Centerline (180mm)	SRAM Centerline (180mm)	SRAM Centerline (180mm)	
<b>SHIFTER</b>	SRAM XO1 Eagle	SRAM GX Eagle	SRAM NX Eagle MMX	
<b>DERAILLEUR</b>	SRAM XO1 Eagle	SRAM GX Eagle	SRAM NX Eagle	
<b>CASSETTE</b>	SRAM XG 1295 (10-50t)	SRAM XG 1275 (10-50t)	SRAM PG 1230 (11-50t)	
<b>CHAIN</b>	SRAM GX Eagle	SRAM GX Eagle	SRAM NX Eagle	
<b>CRANK</b>	SRAM X1 Carbon DUB (32t/170mm) All Sizes	SRAM Stylo 7K DUB (32t/170mm) X-Small 165mm	SRAM Stylo 6k DUB (32t/170mm) X-Small 165mm	
<b>WHEELSET</b>	DT Swiss M1700 Spline 30	Stans Flow S1 Team	Stans Flow D/Novatech D791SB/D462SB	
<b>TIRE/FRONT</b>	Maxxis Assegai 3C EXO+ (27.5x2.5)	Maxxis Assegai 3C EXO+ (27.5x2.5)	Maxxis Assegai 3C EXO+ (27.5x2.5)	
<b>TIRE/REAR</b>	Maxxis Minion DHR11 3C EXO+ (27.5x2.4)	Maxxis Minion DHR11 3C EXO+ (27.5x2.4)	Maxxis Minion DHR11 3C EXO+ (27.5x2.4)	
<b>INCLUDED</b>	Tubeless Valves & Stans Sealant (6oz)	Tubeless Valves & Stans Sealant (6oz)	Tubeless Valves & Stans Sealant (6oz)	
<b>WEIGHT</b>	30.4 lbs / 13.79 kg (Size MD)	31.0 lbs / 14.06 kg (Size MD)	31.5 lbs / 14.29 kg (Size MD)	7.05 lbs / 3.20 kg (Size MD w/shock)

Specs are subject to change at any time.

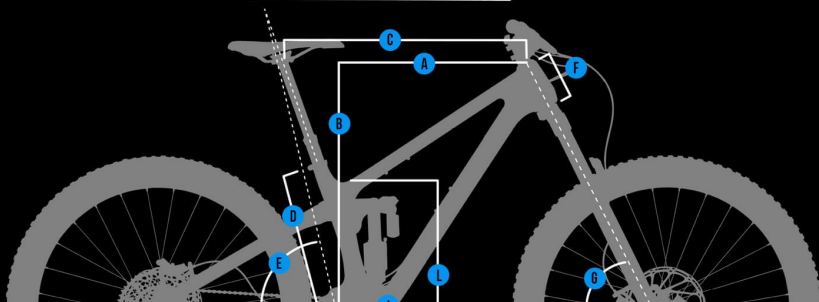

## SPEED BALANCED GEOMETRY

SBG ensures the bike maintains low speed agility, front wheel traction, and proper rider weight balance while actually increasing confidence in steep terrain and at high speeds. With SBG, a slacker head tube angle is combined with a all new reduced offset fork standard, preventing the front wheel from being too far in front of the rider. This improves front to rear weight distribution on the bike, which is often out of balance on long and slack bikes. One of SBG's greatest benefits is that it creates a confident steering feel that adapts to wheel speed. More stability when going fast, more agility on technical slow speed maneuvering as well as improved traction, control and confidence for any skill level of rider.

**LEARN MORE ABOUT SBG**



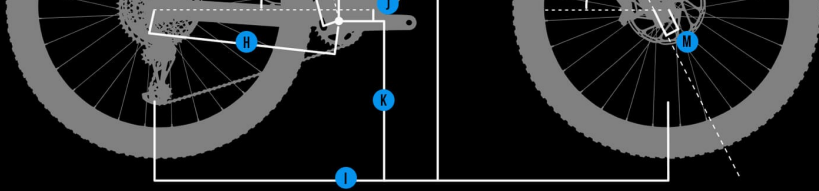

	XS	SM	MD	LG	XL
A. REACH	410	435	460	485	510
B. STACK	577	590	604	617	631
C. EFFECTIVE TT LENGTH	534	564	593	623	652
D. SEAT TUBE LENGTH	350	360	390	430	460
E. EFFECTIVE ST ANGLE	78.2°	77.7°	77.2°	76.8°	76.4°
SADDLE HEIGHT FOR EFFECTIVE ST ANGLE	560	600	660	720	780
ACTUAL ST ANGLE	72°	72°	72°	72°	72°
SEAT TUBE OFFSET AT BB	63	63	63	63	63
F. HEAD TUBE LENGTH	95	110	125	140	155
G. HEAD TUBE ANGLE	64.0°	64.0°	64.0°	64.0°	64.0°
H. CHAINSTAY LENGTH	430	430	430	430	430
I. WHEELBASE	1153	1185	1217	1248	1280
J. BOTTOM BRACKET DROP	18	18	18	18	18
K. ESTIMATED BB HEIGHT	337	337	337	337	337
L. STAND OVER HEIGHT	665	665	673	686	698
M. FORK OFFSET	37	37	37	37	37

[CHECK OUT OUR SIZING GUIDE](#)

[UNDERSTANDING EFFECTIVE SEAT TUBE ANGLE](#)

## FRAME FEATURES



### 1. LIFETIME WARRANTY

At Transition Bikes we take pride in the quality of our products and are stoked to offer a lifetime warranty for the original owner and our stellar crash replacement program. We got your back so you don't have to worry about your bike.



### 2. ALL CARBON CONSTRUCTION

Full carbon frame made from premium Japanese Toray fiber with a tailored blend of 24T and 30T materials to create the right balance of frame stiffness, strength, and impact toughness. Our unique latex coated EPS molding process allows for sharper frame lines and tighter edge radius control with maximum strength to weight ratio and less wasted material.

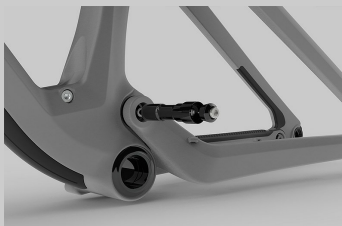

### 3. PIVOT TECHNOLOGY

Collet main pivot technology improves rear end stiffness and keeps your pivot hardware tight. Additional bearing shields prevent main pivot bearing contamination when washing your bike or riding in wet conditions.



## GIDDYUP SUSPENSION DESIGN



We want to make it as easy as possible to experience great rear suspension performance. The GiddyUp suspension system is designed to behave intuitively across a broad range of setup. Because, we get it, sometimes you just want to grab your bike and GiddyUp, without checking your setup. When you do, it will always feel good.

We did this by balancing a 25% progressive leverage curve with a consistent linear rate of change. Anti-squat is tuned to enhance pedaling performance and acceleration. Overall chain growth is moderate and reduces after sag so chain tension doesn't get in the way of the suspension working.

This translates to killer small bump compliance and great mid-stroke support that gradually transitions into an end of stroke ramp that is subtle, yet supportive. The amount of consistent progression is carefully optimized for both air and coil shocks. Riders are able to add or remove volume spacers in air shocks to suite their individual riding style and there is no compromise to bottom out support with coil shocks. The Scout has 140mm of rear wheel travel when used with the supplied 205mm x 57.5mm stroke shock. It is also possible to install a longer, 205mm x 62.5mm stroke shock, to increase the rear wheel travel to 150mm.

A wide usable sag range of 25 - 35% allows the rider to tune the feel of the bike; from poppy and playful, to planted for plowing. Wherever you end up, you can focus on the trail without remotes, levers or knobs. Just grab your bike and GiddyUp.

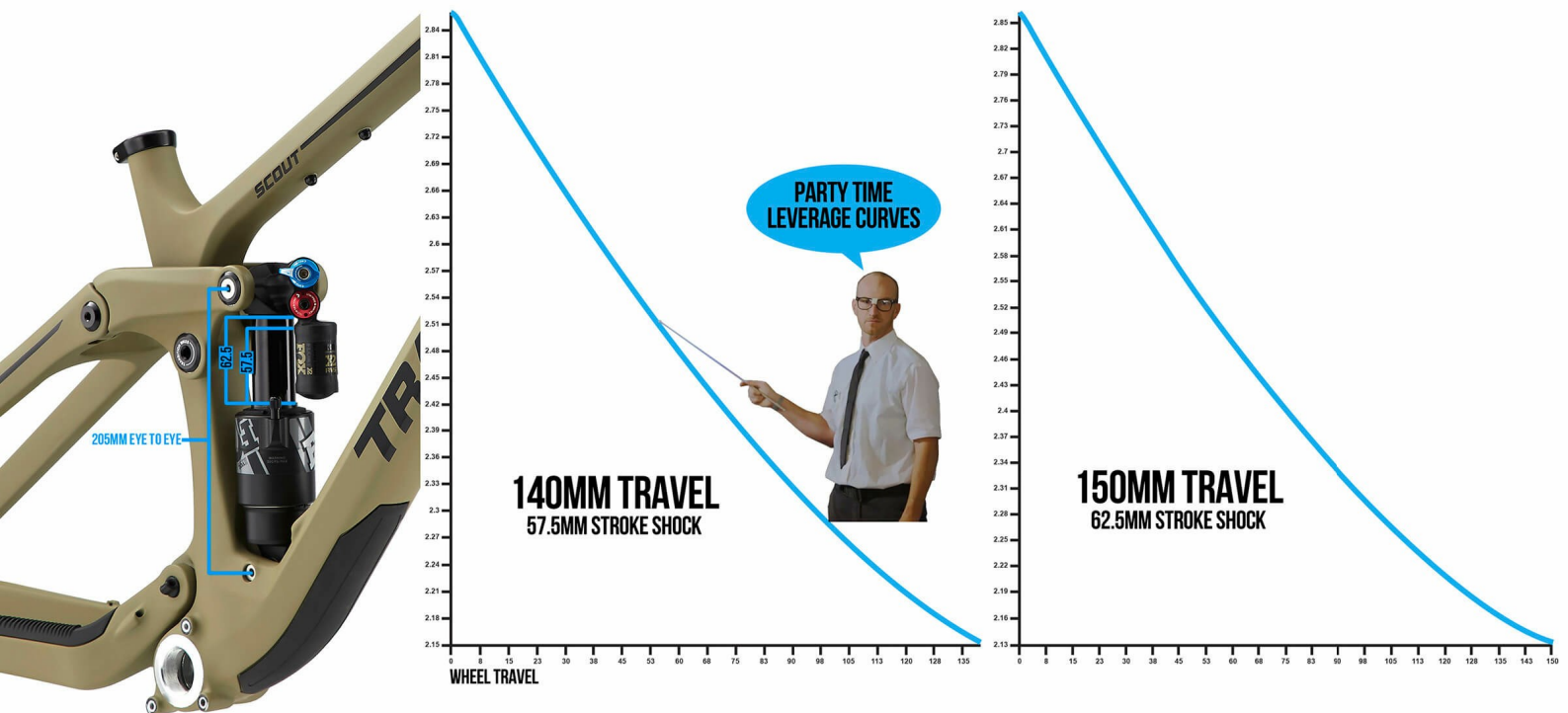

## VITALMTB

"THE SLEEK, HIGHLY-REFINED CARBON FRAME IS EYE-CATCHING, TO SAY THE LEAST. STARE TOO LONG AT THOSE FORMS AND YOU WOULD BE FORGIVEN IN MISSING THE TWEAKED GEOMETRY AND INCREASED TRAVEL NUMBERS. THROW A LEG OVER THE NEW SCOUT AND ALL BECOMES CLEAR. THE 2020 TRANSITION SCOUT DOESN'T JUST PARTY, IT PARTIES HARDER.

WITH A BIKE THAT IS INCREDIBLY FUN ON THE TRAIL AND IMMENSELY CONFIDENT IN THE ROUGH STUFF, WE HAVE TO TIP OUR HAT TO THE GANG AT TRANSITION. IN A MARKET RIFE WITH "UPDATES" THAT ARE LITTLE MORE THAN MARKETING HYPE, THE BAND FROM BELLINGHAM HAVE REBUILT THE SCOUT IN A MEANINGFUL WAY AND PRODUCED A STELLAR BIKE THAT WE CANNOT WAIT TO RIDE EVERY TIME WE WALK TO THE GARAGE." - VITALMTB - [FULL REVIEW HERE](#)

## pb PINKBIKE

"THE NEW CARBON SCOUT IS FOR RIDERS WHO ARE LOOKING FOR A VERSATILE AND CAPABLE 27.5" BIKE THAT'S ALL ABOUT DELIVERING AN EXTRA-FUN TIME ON THE TRAILS. IT TICKS THE NIMBLE AND PLAYFUL BOXES, AND IT'S A BIKE THAT I TRULY ENJOY RIDING IN A VARIETY OF CONDITIONS. AS AN ODE TO THE BOTTLEROCKET, THE SCOUT DELIVERS AND THEN SOME." - PINKBIKE.COM - [FULL REVIEW HERE](#)



"THE MID-TRAVEL, MEDIUM WHEELED BIKE BEGS TO FLICKED ABOUT DURING LOOSE DESCENTS, AND SEEMS NOT TO MIND THE PEDAL BACK UP IN THE SLIGHTEST, SO HATS OFF TO THE SCOUT FOR REMINDING US WHY WE LOVE MOUNTAIN BIKING."

- MTB-MAG.COM - [FULL REVIEW HERE](#)

### △singletracks

"THE LOW, AGGRESSIVELY POISED DIMENSIONS ON THE SCOUT GAVE ME THE FEELING THAT I COULD ATTACK AND PICK UP SPEED ON LONG DESCENTS, AND AS SOON AS I WANTED TO TURN ANYTHING INTO A KICKER OR A JUMP, IT WAS ALSO READY."

- [FULL REVIEW HERE](#)



PHOTO: SKYE SCHLHAMMER / RIDER: JOHN RICHARDSON / LOCATION: BC CANADA

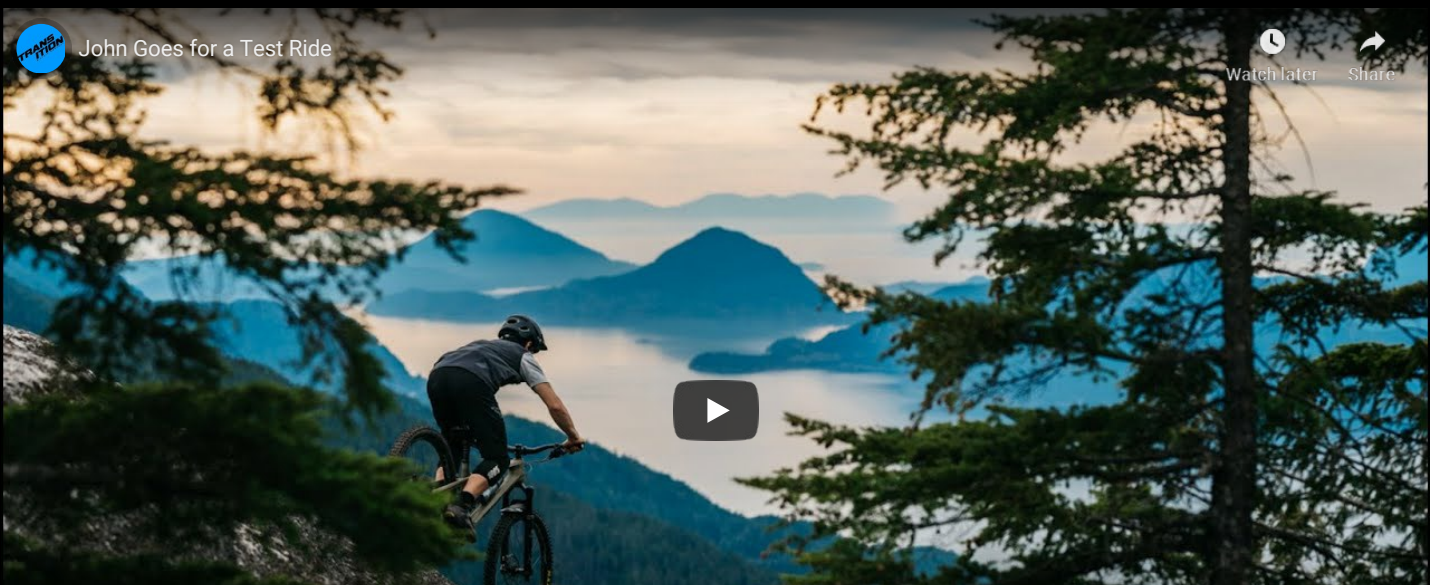

John Goes for a Test Ride

Watch later Share



# JOHN GOES FOR A TEST RIDE

## FRAME SPECIFICATIONS

REAR TRAVEL:	140mm (Compatible with 150mm)
FRONT TRAVEL:	150mm
WHEEL SIZE:	27.5"
SIZES:	XS, SM, MD, LG, XL
COLORS:	Midnight Blue, Olive Green
FRAME BEARINGS:	2x 6903, 2x 6902, 4x 6802, 2x 3802, 2x 6900
FORK AXLE TO CROWN:	545mm
FORK OFFSET:	37mm
REAR SHOCK SIZE:	205mm x 57.5mm (Compatible with a 205mm x 62.5mm shock)
SHOCK HARDWARE:	Trunion Mount Top / 25mm x 8mm Bottom
HEADSET (TOP):	44mm Zero Stack
HEADSET (BOTTOM):	56mm Zero Stack
BB SHELL:	73mm BSA Threaded
REAR BRAKE MOUNT:	180mm Post Mount
REAR AXLE:	Syntace X12 148, with a 1.0mm thread pitch
ISCG TABS:	ISCG05
SEATPOST DIAMETER:	31.6mm
SEAT CLAMP:	37.0mm
MAX SEATPOST INSERTION:	XS 210mm   Small 220mm   Medium 250mm   Large 290mm   XL 320mm
MAX CHAINRING SIZE:	34T Single Ring
MAX TIRE SIZE:	27.5 x 2.6
REAR SHOCK SAG:	140mm/57.5mm: 15-19mm (26-33%) 150mm/62.5mm: 16-20mm (26-32%)

## FAQ'S

HOW CAN I TRY A BIKE BEFORE I BUY?

WHAT SIZE DO I NEED?

DO YOU OFFER FINANCING?

WHAT KIND OF WARRANTY DOES THE SCOUT COME WITH?

HOW WILL MY BIKE SHOW UP, HOW MUCH ASSEMBLY IS REQUIRED?

CAN I RUN A COIL SHOCK ON THIS BIKE?

CAN I RUN A FORK WITH MORE OFFSET?

CAN I RUN A FORK WITH A DIFFERENT AMOUNT OF TRAVEL?

WHERE CAN I FIND THE TORQUE SPECS FOR SCOUT FRAME?

CAN I MOUNT A CHAIN GUIDE/BASH GUARD TO THIS FRAME?

DOES THIS FRAME FIT A WATER BOTTLE?



***DON'T BE A STRANGER, STAY CONNECTED***

Enter Your Email

SUBSCRIBE



**TRANSITION HQ**

1600 Carolina Street  
Bellingham, WA 98229  
(360) 366-4960  
info@transitionbikes.com

**ABOUT US**

FACTORY STORE  
TEAM  
EMPLOYMENT  
OPPORTUNITIES

**BIKES**

SPUR  
SCOUT  
SENTINEL  
PATROL  
TR11  
RIPCORD  
PBJ  
CLOSEOUT BIKES

**COMPONENTS**

SADDLES  
STEMS  
HANDLEBARS  
PEDALS

**GEAR**

CLOTHING  
ACCESSORIES  
SUPPORT PARTS

**DEMO & EVENTS**

SCHEDULE A FACTORY  
DEMO  
FIND A DEMO DEALER  
FIND AN EVENT

**DEALERS**

FIND A DEALER  
INTERNATIONAL  
DISTRIBUTORS

**SUPPORT**

BIKE ARCHIVE  
WARRANTY  
REGISTER YOUR BIKE  
TERMS & CONDITIONS  
RETURN POLICY  
PRIVACY POLICY  
PRO-FORM PROGRAM



TRANSITION BICYCLE COMPANY™ 2020

Are You Ready To GiddyUp?