



# SCOUT

140MM REAR / 150MM FRONT / 27.5 WHEELS

**SCOUT**

[OVERVIEW/BUY](#) [BUILD SPECS](#) [FEATURES](#) [SBG GEOMETRY](#) [REVIEWS](#) [FRAME SPECS](#) [FAQ'S](#) [SUPPORT/SETUP](#)



## THE COMPOSED SPORT BIKE

Hop on the Scout and you're immediately transformed into a projectile.

The Scout will awaken your inner child. Manual here, scrub that, skid there, pedal up this. Freedom to boost everything in sight, overshoot every landing without a care, mixed with nose bonking and hooting your way down the trail. Sporty, but just as eager to tackle bigger terrain. The Scout's trail charisma is infectious and will cause you to look at your regular trails through a new

### SELECT BUILD

- ALLOY **NX** \$4,099 USD
- ALLOY **GX** \$5,299 USD
- CARBON **GX** \$6,299 USD
- CARBON **XT** \$6,299 USD

perspective. Pedal up and repeat.

AVAILABLE COLORS:

- MIDNIGHT BLUE (CARBON)
- OLIVE GREEN (CARBON)
- GLASSY BLACK (ALLOY)
- RASPBERRY (ALLOY)

**ALLOY FRAMESET \$2,199 USD**

**SELECT SIZE/COLOR**

- X-Small Ships Now
- X-Small Ships appx. 3+ Months
- Small Ships Now
- Small Ships Now
- Medium Ships Now
- Medium Ships Now
- Large Ships Now
- Large Ships Now

**\$4,099.00 USD**

IN STOCK: This item will ship within 2 business days

[ADD TO CART](#)



	<b>CARBON XG1</b>	<b>CARBON GX</b>	<b>CARBON XT</b>	<b>ALLOY GX</b>	<b>ALLOY NX</b>	<b>CARBON FRAMESET</b>	<b>ALLOY FRAMESET</b>
<b>FRAME</b>	Scout Carbon 140mm	Scout Carbon 140mm	Scout Carbon 140mm	Scout Alloy 140mm	Scout Alloy 140mm	Scout Carbon 140mm	Scout Alloy 140mm
<b>REAR SHOCK</b>	Fox Float X2 Factory 2 Position	RockShox Super Deluxe Ultimate	Fox Float X2 Performance 2 Position	Fox Float X Performance Elite 2 Position	Fox Float X Performance 2 Position	Fox Float X2 Factory 2 Position	Fox Float X Performance Elite 2 Position
<b>FORK</b>	Fox Float 36 Grip 2 Factory 150mm Travel/37mm Offset	RockShox Lyrik Ultimate 150mm Travel/37mm Offset	Fox Float 36 Grip Performance 150mm Travel/37mm Offset	Fox Float 36 Grip 2 Performance Elite 150mm Travel/37mm Offset	Fox Float 36 Rhythm 150mm Travel/37mm Offset		
<b>HEADSET</b>	Cane Creek 40 Series	FSA No.57E	FSA No.57E	FSA No.57E	FSA No.57E		
<b>STEM</b>	ANVL Swage (40mm)	ANVL Swage (40mm)	ANVL Swage (40mm)	ANVL Swage (40mm)	RaceFace Aeffect R (40mm)		
<b>HANDLEBAR</b>	OneUp Carbon Bar XS/SM (800x20) MD/LG/XL (800x35)	ANVL Mandrel Alloy 35 XS/SM (800x20) MD/LG (800x30) XL (800x 40)	ANVL Mandrel Alloy 35 XS/SM (800x20) MD/LG (800x30) XL (800x 40)	ANVL Mandrel Alloy 35 XS/SM (800x20) MD/LG (800x30) XL (800x 40)	RaceFace Chester 35 XS/SM (780x20) MD/LG (780x35)		
<b>GRIPS</b>	ODI Elite Flow	ODI Elite Flow	ODI Elite Flow	ODI Elite Flow	ODI Elite Flow		
<b>SADDLE</b>	ANVL Forge Ti	ANVL Forge Cromo	ANVL Forge Cromo	ANVL Forge Cromo	ANVL Forge Cromo		
<b>SEATPOST</b>	OneUp Dropper Post XS (120mm) SM (150mm) MD (180mm) LG/XL (210mm)	OneUp Dropper Post XS (120mm) SM (150mm) MD (180mm) LG/XL (210mm)	OneUp Dropper Post XS (120mm) SM (150mm) MD (180mm) LG/XL (210mm)	OneUp Dropper Post XS (120mm) SM (150mm) MD (180mm) LG/XL (210mm)	OneUp Dropper Post XS (120mm) SM (150mm) MD (180mm) LG (210mm)		
<b>BRAKES</b>	SRAM Code RSC	SRAM Code RSC	Shimano XT M8120	TRP DHR Evo	SRAM Code R or SRAM Guide RE 4-Piston		
<b>ROTORs</b>	SRAM Centerline (180mm)	SRAM Centerline (180mm)	Shimano RT86 (180mm)	TRP R1 2.3 (180mm)	SRAM Centerline (180mm)		
<b>SHIFTER</b>	SRAM XO1 Eagle	SRAM GX Eagle	Shimano XT M8100	SRAM GX Eagle MMX	SRAM NX Eagle MMX		
<b>DERAILLEUR</b>	SRAM XO1 Eagle	SRAM GX Eagle	Shimano XT M8100	SRAM GX Eagle	SRAM NX Eagle		
<b>CASSETTE</b>	SRAM XG 1295 (10-52t)	SRAM XG 1275 (10-52t)	Shimano SLX M7100 (10-51t)	SRAM XG 1275 (10-52t)	SRAM PG 1230 (11-50t)		
<b>CHAIN</b>	SRAM GX Eagle	SRAM GX Eagle	Shimano XT M8100	SRAM GX Eagle	SRAM NX Eagle		
<b>CRANK</b>	SRAM X1 Carbon DUB (XS 30t-165mm/SM,MD,LG,XL 30t-170mm)	SRAM Stylo 7K DUB (XS 30t-165mm/SM,MD,LG,XL 30t-170mm)	Shimano XT M8100 (XS 30t-165mm/SM,MD,LG,XL 30t-170mm)	SRAM GX Eagle DUB (30t-170mm)	SRAM Descendent 6k DUB (30t-165mm)		
<b>RIMS</b>	DT Swiss XM 1700 Spline 30	Stans Flow S1	Stans Flow S1	DT Swiss M 1900 Spline 30	Stans Flow D		
<b>SPOKES</b>	DT Swiss Competition	Sapim Race Double Butted	Sapim Race Double Butted	DT Swiss Champion	Pillar Double Butted		
<b>HUBS</b>	DT Swiss 350 Straight Pull 36SL	Stans Neo Durasync	Stans Neo Durasync	DT Swiss 370 Ratchet LN	Novatech D791SB/D902SB		
<b>TIRE/FRONT</b>	Maxxis Assegai 3C EXO+ (27.5x2.5)	Maxxis Assegai 3C EXO+ (27.5x2.5)	Maxxis Assegai 3C EXO+ (27.5x2.5)	Maxxis Assegai 3C EXO+ (27.5x2.5)	Maxxis Assegai 3C EXO+ (27.5x2.5)		
<b>TIRE/REAR</b>	Maxxis Minion DHR11 3C EXO+ (27.5x2.4)	Maxxis Minion DHR11 3C EXO+ (27.5x2.4)	Maxxis Minion DHR11 3C EXO+ (27.5x2.4)	Maxxis Minion DHR11 3C EXO+ (27.5x2.4)	Maxxis Minion DHR11 3C EXO+ (27.5x2.4)		
<b>INCLUDED</b>	Tubeless Valves & Sealant	Tubeless Valves & Sealant	Tubeless Valves & Sealant	Tubeless Valves & Sealant	Tubeless Valves & Sealant		
<b>WEIGHT</b>	30.4 lbs / 13.79kg (Size MD)	31 lbs / 14.06kg (Size MD)	31 lbs / 14.06kg (Size MD)	33.4 lbs / 15.15 kg (Size MD)	34.9 lbs / 15.83 kg (Size MD)	7 lbs / 3.20kg (Size MD w/shock)	9.5 lbs / 4.31 kg (Size MD w/shock)

Specs are subject to change at any time.

## FRAME FEATURES



### 1. LIFETIME WARRANTY

At Transition Bikes we take pride in the quality of our products and are stoked to offer a lifetime warranty for the original owner and our stellar crash replacement program. We got your back so you don't have to worry about your bike.



### 2. FRAME MATERIAL

The Scout carbon uses premium Japanese Toray fiber using a unique latex coated EPS molding process to create tighter edge radius control using less material. The Scout alloy features a frame made from tough and dependable heat treated 6061 aluminum to strike the right balance of strength, durability and ride quality.

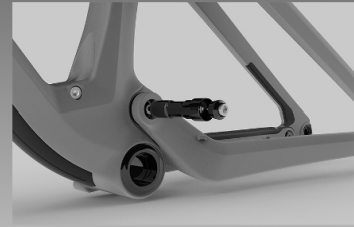

### 3. PIVOT TECHNOLOGY

Collet main pivot technology improves rear end stiffness and keeps your pivot hardware tight. Additional bearing shields prevent main pivot bearing contamination when washing your bike or riding in wet conditions.

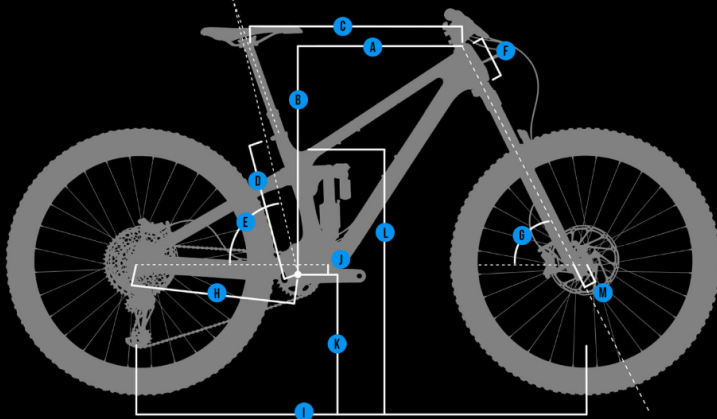

## SPEED BALANCED GEOMETRY

SBG ensures the bike maintains low speed agility, front wheel traction, and proper rider weight balance while actually increasing confidence in steep terrain and at high speeds. With SBG, a slacker head tube angle is combined with a all new reduced offset fork standard, preventing the front wheel from being too far in front of the rider. This improves front to rear weight distribution on the bike, which is often out of balance on long and slack bikes. One of SBG's greatest benefits is that it creates a confident steering feel that adapts to wheel speed. More stability when going fast, more agility on technical slow speed maneuvering as well as improved traction, control and confidence for any skill level of rider.

### LEARN MORE ABOUT SBG

	XS	SM	MD	LG	XL
A. REACH	410	435	460	485	510
B. STACK	577	590	604	617	631
C. EFFECTIVE TT LENGTH	534	564	593	623	652
D. SEAT TUBE LENGTH	350	360	390	430	460
E. EFFECTIVE ST ANGLE	78.2°	77.7°	77.2°	76.8°	76.4°
SADDLE HEIGHT FOR EFFECTIVE ST ANGLE	560	600	660	720	780
ACTUAL ST ANGLE	72°	72°	72°	72°	72°
SEAT TUBE OFFSET AT BB	63	63	63	63	63
F. HEAD TUBE LENGTH	95	110	125	140	155
G. HEAD TUBE ANGLE	64.0°	64.0°	64.0°	64.0°	64.0°
H. CHAINSTAY LENGTH	430	430	430	430	430
I. WHEELBASE	1153	1185	1217	1248	1280
J. BOTTOM BRACKET DROP	18	18	18	18	18
K. ESTIMATED BB HEIGHT	337	337	337	337	337
L. STAND OVER HEIGHT	665	665	673	686	698
M. FORK OFFSET	37	37	37	37	37

[CHECK OUT OUR SIZING GUIDE](#)

[UNDERSTANDING EFFECTIVE SEAT TUBE ANGLE](#)



# GIDDYUP SUSPENSION DESIGN

We want to make it as easy as possible to experience great rear suspension performance. The GiddyUp suspension system is designed to behave intuitively across a broad range of setup. Because, we get it, sometimes you just want to grab your bike and GiddyUp, without checking your setup. When you do, it will always feel good.

We did this by balancing a 24% progressive leverage curve with a consistent linear rate of change. Anti-squat is tuned to enhance pedaling performance and acceleration. Overall chain growth is moderate and reduces after sag so chain tension doesn't get in the way of the suspension working.

This translates to killer small bump compliance and great mid-stroke support that gradually transitions into an end of stroke ramp that is subtle, yet supportive. The amount of consistent progression is carefully optimized for both air and coil shocks. Riders are able to add or remove volume spacers in air shocks to suite their individual riding style and there is no compromise to bottom out support with coil shocks. The Scout has 140mm of rear wheel travel when used with the supplied 205mm x 57.5mm stroke shock. It is also possible to install a longer, 205mm x 62.5mm stroke shock, to increase the rear wheel travel to 150mm.

A wide usable sag range of 25 - 35% allows the rider to tune the feel of the bike; from poppy and playful, to planted for plowing. Wherever you end up, you can focus on the trail without remotes, levers or knobs. Just grab your bike and GiddyUp.

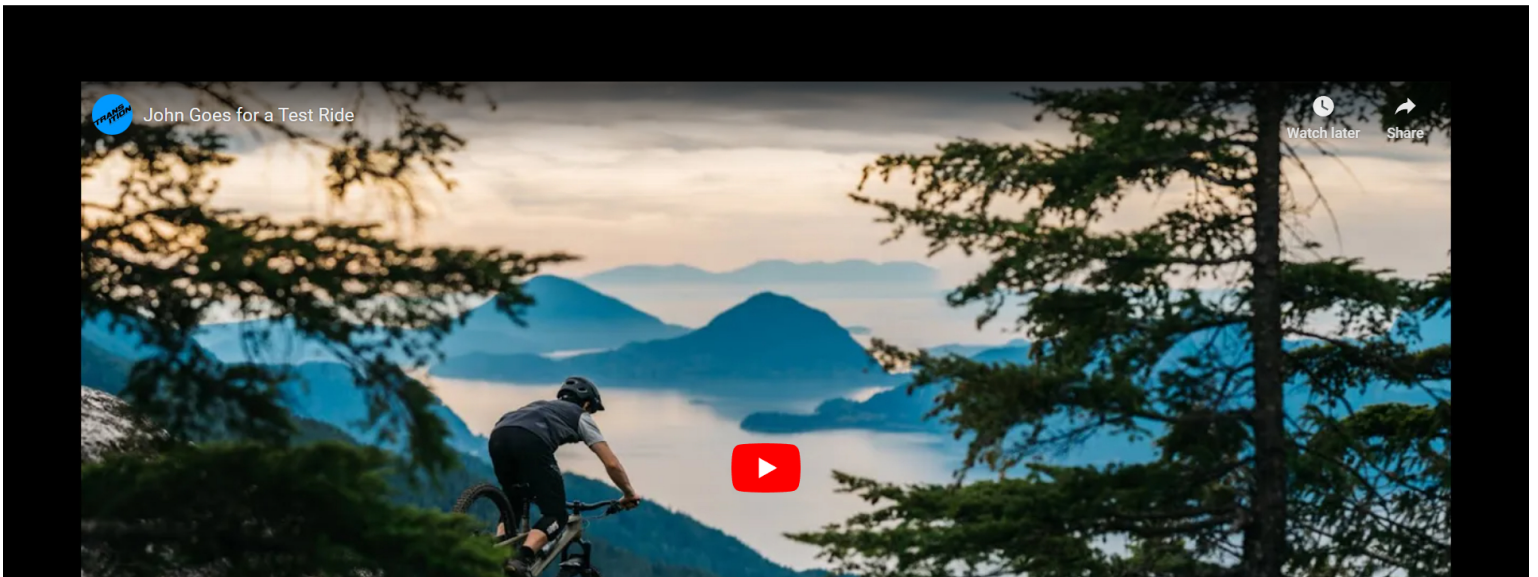
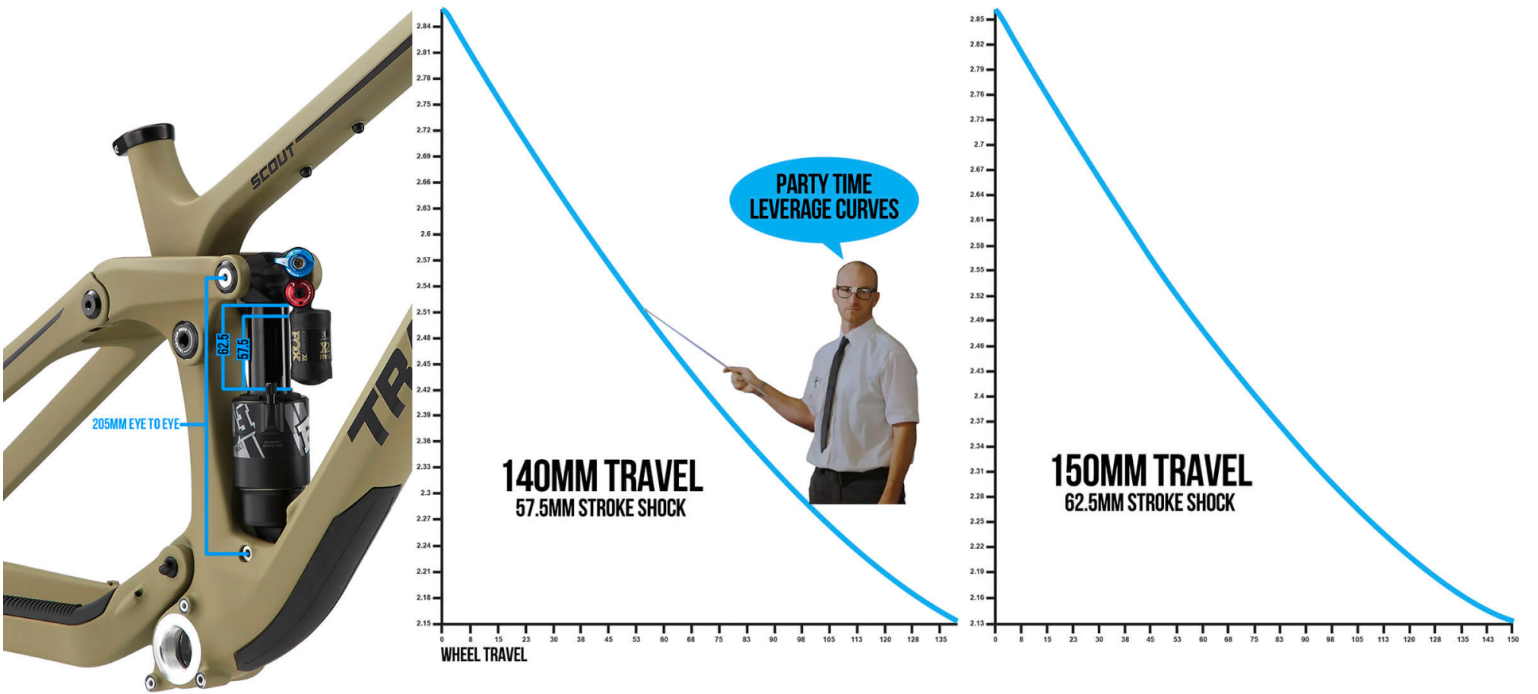

# JOHN GOES FOR A TEST RIDE

Watch on  YouTube

## VITALMTB

"THE SLEEK, HIGHLY-REFINED CARBON FRAME IS EYE-CATCHING, TO SAY THE LEAST. STARE TOO LONG AT THOSE FORMS AND YOU WOULD BE FORGIVEN IN MISSING THE TWEAKED GEOMETRY AND INCREASED TRAVEL NUMBERS. THROW A LEG OVER THE NEW SCOUT AND ALL BECOMES CLEAR. THE 2020 TRANSITION SCOUT DOESN'T JUST PARTY, IT PARTIES HARDER.

WITH A BIKE THAT IS INCREDIBLY FUN ON THE TRAIL AND IMMENSELY CONFIDENT IN THE ROUGH STUFF, WE HAVE TO TIP OUR HAT TO THE GANG AT TRANSITION. IN A MARKET RIFE WITH "UPDATES" THAT ARE LITTLE MORE THAN MARKETING HYPE, THE BAND FROM BELLINGHAM HAVE REBUILT THE SCOUT IN A MEANINGFUL WAY AND PRODUCED A STELLAR BIKE THAT WE CANNOT WAIT TO RIDE EVERY TIME WE WALK TO THE GARAGE." - VITALMTB - [FULL REVIEW HERE](#)

## PINKBIKE

"THE NEW CARBON SCOUT IS FOR RIDERS WHO ARE LOOKING FOR A VERSATILE AND CAPABLE 27.5" BIKE THAT'S ALL ABOUT DELIVERING AN EXTRA-FUN TIME ON THE TRAILS. IT TICKS THE NIMBLE AND PLAYFUL BOXES, AND IT'S A BIKE THAT I TRULY ENJOY RIDING IN A VARIETY OF CONDITIONS. AS AN ODE TO THE BOTTLEROCKET, THE SCOUT DELIVERS AND THEN SOME." - PINKBIKE.COM - [FULL REVIEW HERE](#)

## MTB-MAG.COM

"THE MID-TRAVEL, MEDIUM WHEELED BIKE BEGS TO FLICKED ABOUT DURING LOOSE DESCENTS, AND SEEMS NOT TO MIND THE PEDAL BACK UP IN THE SLIGHTEST, SO HATS OFF TO THE SCOUT FOR REMINDING US WHY WE LOVE MOUNTAIN BIKING." - MTB-MAG.COM - [FULL REVIEW HERE](#)

## SINGLETRACKS

"THE LOW, AGGRESSIVELY POISED DIMENSIONS ON THE SCOUT GAVE ME THE FEELING THAT I COULD ATTACK AND PICK UP SPEED ON LONG DESCENTS, AND AS SOON AS I WANTED TO TURN ANYTHING INTO A KICKER OR A JUMP, IT WAS ALSO READY." - SINGLETRACKS.COM - [FULL REVIEW HERE](#)



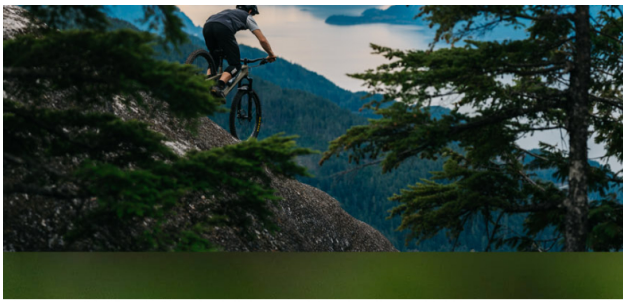

PHOTO: SKYE SCHILLHAMMER / RIDER: JOHN RICHARDSON / LD

## FRAME SPECIFICATIONS

REAR TRAVEL:	140mm (Compatible with 150mm)
FRONT TRAVEL:	150mm
WHEEL SIZE:	27.5"
SIZES:	Carbon: XS, SM, MD, LG, XL Alloy: XS, SM, MD, LG
COLORS:	Carbon: Midnight Blue, Olive Green Alloy: Classy Black, Raspberry Red
FRAME BEARINGS:	2x 6903, 2x 6902, 4x 6802, 2x 3802, 2x 6900
FORK AXLE TO CROWN:	545mm
FORK OFFSET:	37mm
REAR SHOCK SIZE:	205mm x 57.5mm (Compatible with a 205mm x 62.5mm shock)
SHOCK HARDWARE:	Trunnion Mount Top / 25mm x 8mm Bottom
HEADSET (TOP):	44mm Zero Stack
HEADSET (BOTTOM):	56mm Zero Stack
BB SHELL:	73mm BSA Threaded
CHAINLINE:	52mm
REAR BRAKE MOUNT:	180mm Post Mount
REAR AXLE:	Carbon: Syntace X12 148, with a 1.0mm thread pitch Alloy: Transition Axle For UDH, 12mm x 148mm Spacing
ISCG TABS:	ISCG05
SEATPOST DIAMETER:	31.6mm
SEAT CLAMP:	Carbon: 37.0mm Alloy: 34.9mm
MAX SEATPOST INSERTION:	Carbon: XS 210mm   Small 220mm   Medium 250mm   Large 290mm   XL 320mm Alloy: XS 230mm   Small 240mm   Medium 270mm   Large 310mm
MAX CHAINRING SIZE:	34T Single Ring
MAX TIRE SIZE:	27.5 x 2.6
REAR SHOCK SAG:	140mm/57.5mm: 15-19mm (26-33%) 150mm/62.5mm: 16-20mm (26-32%)

## FAQ'S

CAN I MOUNT A CHAIN GUIDE/BASH GUARD TO THIS FRAME?

CAN I PRE-ORDER A BIKE?

CAN I RUN A COIL SHOCK ON THIS BIKE?

CAN I RUN A FORK WITH A DIFFERENT AMOUNT OF TRAVEL?

CAN I RUN A FORK WITH MORE OFFSET?

CAN I TRY A BIKE BEFORE I BUY?

DO YOU OFFER FINANCING?

DOES THIS FRAME FIT A WATER BOTTLE?

HOW DO I FIND TRACKING FOR MY SHIPMENT?

HOW WILL MY BIKE SHOW UP, HOW MUCH ASSEMBLY IS REQUIRED?

WHAT IS THE RECOMMENDED SAG FOR THIS BIKE?

WHAT IS THE WARRANTY POLICY FOR THIS MODEL?

WHAT IS THE WIDEST TIRE THIS BIKE WILL FIT?

WHAT IS THE WIDEST TIRE THIS BIKE WILL FIT?

WHAT SIZE DO I NEED?

WHERE CAN I FIND THE TORQUE SPECS FOR SCOUT FRAME?

## DON'T BE A STRANGER, STAY CONNECTED

Enter Your Email

SUBSCRIBE



### TRANSITION HQ

5090 Samish Way  
Bellingham, WA 98229 USA  
(360) 366-4960  
info@transitionbikes.com

### ABOUT US

WHAT'S UP  
OUR COMMITMENT TO OUR  
CUSTOMERS  
CONTACT US  
TRANSITION OUTPOST BIKE SHOP  
WHO WE ARE  
OUR VIDEOS  
TEAM & AMBASSADORS  
GIVING BACK  
EMPLOYMENT OPPORTUNITIES

### BIKES

TR11  
RELAY  
REPEATER  
SPIRE  
PATROL  
SMUGGLER  
SPUR  
SENTINEL  
SCOUT  
RIPCORD  
PBJ  
CLOSEOUTS

### GEAR

COMPONENTS  
CLOTHING  
ACCESSORIES  
REPLACEMENT PARTS  
CLOSEOUTS

### DEMO & DEALERS

SCHEDULE A FACTORY DEMO  
FIND AN EVENT  
DEALERS

### SUPPORT

PRODUCT SUPPORT  
WARRANTY SUPPORT  
POLICIES  
INDUSTRY PROFORM

### OTHER

MY ACCOUNT  
MY SHOPPING CART  
FOLLOW US ON FACEBOOK  
FOLLOW US ON INSTAGRAM  
TRANSITION VIDEOS  
CONNECT WITH US

**TRANSITION**  
BICYCLE COMPANY

TRANSITION BICYCLE COMPANY™ 2023

Are You Ready To GiddyUp?

Chat